

wellead®

WELL LEAD MEDICAL CO., LTD.

Address: 47 Guomao Avenue South, Panyu, Guangzhou, China
Tel: +86-20-84758878 Fax: +86-20-84758224 Post Code: 511434
Marketing & Trading Office
Add: RM 805, No 55, 21 Long, Pusan Road, Shanghai, China
Tel: +86-21-58397623 Fax: +86-21-58397615 Post code: 200125
E-mail: info@wellead.com.cn www.wellead.com



Distributed by

wellead®

ConviCath®

Continence Care Solution



Intermittent Catheterization

Chronic urinary retention leading to bladder dysfunction poses a significant challenge for affected individuals, not only due to the potential for serious complications but also because of its profound impact on their quality of life.

Intermittent Catheterization (IC) is the “gold standard” for individuals with bladder dysfunction caused by neurologic or non-neurologic causes.

What Guideline Says

Guideline recommends IC over other catheter-based options

According to the 6th International Consultation on Incontinence, IC has replaced long-term indwelling urinary catheterization for patients with neurogenic lower urinary tract dysfunction (NLUTD) resulting in incomplete bladder emptying, as it is associated with fewer urologic and non-urologic complications.

Current Association of French Urologists, European Association of Urology (EAU), American Urological Association (AUA), and the Healthcare Infection Control Practices Advisory Committee (HICPAC) guidelines recommend IC over other catheter-based options (Gamé et al, 2020; Groen, 2016, Averch, 2014, Gould, 2009).

Benefits of Using Intermittent Self-Catheterization

Intermittent self-catheterization offers a gentle and effective solution for managing voiding disorders, improving quality of life in several ways:

Reduces UTI risk:

Unlike indwelling catheters, intermittent catheters minimize the risk of infection by not remaining in the body.

Enhances freedom and independence:

Enables bladder management at convenient times and places, empowering individuals to participate more fully in daily activities.

Preserves bladder function:

Complete bladder emptying reduces residual urine, minimizing restroom visits, leakage, and associated complications.

User-friendly:

With practice and proper instruction, many find IC easy and safe to perform independently.

ConviCath®

Continence Care Solution

Tailored for patients with chronic urine retention due to neurogenic and non-neurogenic voiding issues.

For Women



ConviCath® Mini
Compact Female

ConviCath® Pro
Ready to Use Female



ConviCath®
Female

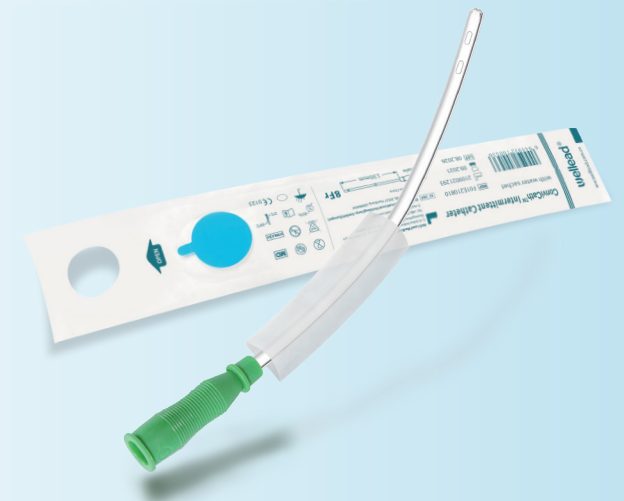

For Men

ConviCath® Mini Compact Standard



ConviCath® Pro Ready to Use Standard/Tiemann



ConviCath® Standard/Tiemann



ConviCath® Hydrophilic Intermittent Catheter

Ensures safety every time while prioritizing your comfort with the following:

Hydrophilic Coating

- The catheter surface is hydrophilic-coated, minimizing friction and trauma to the urethra, thus lowering urinary tract infection risk.
- Smooth insertion and removal reduce discomfort and irritation.

Smooth and Burr-free Drainage Apertures

- The hot-melt punching process ensures smooth and burr-free drainage apertures.
- Minimize the risk of urethral mucosal abrasion during catheterization to enhance safety and patient comfort.

TPU Material

- Made from medical grade TPU material, providing a comfortable insertion experience.
- As an environmentally friendly material, TPU has the capability to safely biodegrade in natural environments, reducing environmental impact.
- Applicable for ConviCath® Pro & ConviCath® Mini series hydrophilic intermittent catheters.

ConviCath® Mini Compact Female

Specially Designed for Women,
Privacy and Comfort On the Go

- Ready-to-use hydrophilic coated catheter.
- Touch-free design.
- Made from TPU for comfort and eco-friendliness.
- Compact and portable for On-the-Go convenience.
- Elegant pink design, perfectly tailored for women.
- Available in multiple sizes to meet various needs.



Tamper-proof label design ensuring peace of mind.



Keep your hands clean during insertion with its dry-wet separation design, reducing risk of infection.



Stylish packaging for easy portability, prioritizing user privacy and dignity.

ConviCath® Mini Compact Standard

Specially Designed for Men,
Privacy and Comfort On the Go



- Provide 100% non-touch protection with a protective tip and sleeve.
- Lubricated hydrophilic catheter for immediate use without additional steps.
- Compact packaging for easy portability.
- Available in multiple sizes to meet different needs.
- Made from TPU for comfort and environmental friendliness.

Protective Sleeve



Provides a barrier throughout the entire insertion process to help prevent the transmission of pathogens that can cause urinary tract infections (UTIs).

Sliding Switch



Slides the switch backward to open the excretion chamber, allowing for one-handed operation and effectively preventing urine splashing.

Silicone Protective Tip



Shields the sterile catheter from bacteria during insertion, thereby reducing the incidence of UTIs.

ConviCath® Pro

Ready-to-Use for Faster Catheterization



Pre-lubricated with the instantly ready-to-use hydrophilic coating, ensuring convenient and simple catheterization every day.



The adhesive tab ensures the catheter stay in place, convenient and effective.

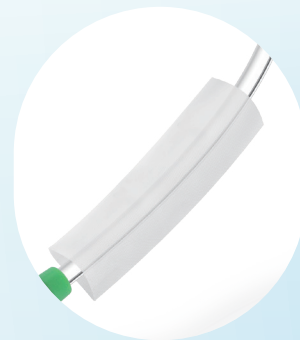

The protective catheter sleeve prevents slippage during insertion, saving time. Its touch-free design greatly minimizes the risk of infection.

ConviCath®

Water Activation, Smooth and Easy

Thumb Grip

Allow the package to be easily opened even if manual dexterity is limited. It can also be used to hang the catheter package.

Adhesive Tab

For reliable attachment to any dry and clean surface, allowing both hands to remain free.

Tube

Flexible tube with atraumatic tip and eyes.

Hydrophilic Coating

Activated easily when the internal water sachet is broken, creating an extremely low friction and slippery surface.

Easy-break Water Sachet

With a gentle squeeze to break the sachet. Water comes out in the direction of the arrow to activate the hydrophilic coating.

Male Connector

Female Connector

Connector

Different design for male and female use. Special ergonomic grip design is easy to control and is tailor made for women's needs.

Hygienic Protective Catheter Sleeve

Touch free design offers full control with no need to touch the catheter tube during insertion, greatly minimizing the risk of infection.

Ordering information

For Women

For Men

ConviCath® Mini Compact Female

Size(Fr/Ch)	Length(mm)	Pack	Cat.No.
8	150	Box of 30	F01L010810
10	150	Box of 30	F01L011010
12	150	Box of 30	F01L011210
14	150	Box of 30	F01L011410
16	150	Box of 30	F01L011610



ConviCath® Mini Compact Standard

Size(Fr/Ch)	Length(mm)	Pack	Cat.No.
8	420	Box of 30	F01L050810
10	420	Box of 30	F01L051010
12	420	Box of 30	F01L051210
14	420	Box of 30	F01L051410
16	420	Box of 30	F01L051610
18	420	Box of 30	F01L051810



ConviCath® Pro Ready to Use Female

Color Code	Size(Fr/Ch)	Length(mm)	Pack	Cat.No.
Blue	8	183	Box of 30	F01L020820
Black	10	183	Box of 30	F01L021020
White	12	183	Box of 30	F01L021220
Green	14	183	Box of 30	F01L021420
Orange	16	183	Box of 30	F01L021620
Red	18	183	Box of 30	F01L021820



ConviCath® Pro Ready to Use Standard

Color Code	Size(Fr/Ch)	Length(mm)	Pack	Cat.No.
Blue	8	408	Box of 30	F01L030830
Black	10	408	Box of 30	F01L031030
White	12	408	Box of 30	F01L031230
Green	14	408	Box of 30	F01L031430
Orange	16	408	Box of 30	F01L031630
Red	18	408	Box of 30	F01L031830



ConviCath® Female

Color Code	Size(Fr/Ch)	Pack	Cat.No. w/o water sachet	Cat.No. with water sachet
Blue	8	Box of 30	F01E160810	F01E230810
Black	10	Box of 30	F01E161010	F01E231010
White	12	Box of 30	F01E161210	F01E231210
Green	14	Box of 30	F01E161410	F01E231410
Orange	16	Box of 30	F01E161610	F01E231610
Red	18	Box of 30	F01E161810	F01E231810
Yellow	20	Box of 30	F01E162010	F01E232010
Violet	22	Box of 30	F01E162210	F01E232210

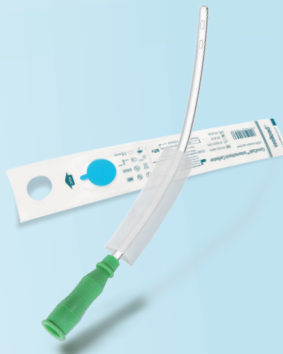

ConviCath® Pro Ready to Use Tiemann

Color Code	Size(Fr/Ch)	Length(mm)	Pack	Cat.No.
Black	10	408	Box of 30	F01L041030
White	12	408	Box of 30	F01L041230
Green	14	408	Box of 30	F01L041430
Orange	16	408	Box of 30	F01L041630
Red	18	408	Box of 30	F01L041830











For
Men









ConviCath® Standard



Color Code	Size(Fr/Ch)	Pack	Cat.No. w/o water sachet	Cat.No. with water sachet
 Blue	8	Box of 30	F01E150810	F01E210810
 Black	10	Box of 30	F01E151010	F01E211010
 White	12	Box of 30	F01E151210	F01E211210
 Green	14	Box of 30	F01E151410	F01E211410
 Orange	16	Box of 30	F01E151610	F01E211610
 Red	18	Box of 30	F01E151810	F01E211810
 Yellow	20	Box of 30	F01E152010	F01E212010
 Violet	22	Box of 30	F01E152210	F01E212210

ConviCath® Tiemann



Color Code	Size(Fr/Ch)	Pack	Cat.No. w/o water sachet	Cat.No. with water sachet
 Black	10	Box of 30	F01E171010	F01E241010
 White	12	Box of 30	F01E171210	F01E241210
 Green	14	Box of 30	F01E171410	F01E241410
 Orange	16	Box of 30	F01E171610	F01E241610
 Red	18	Box of 30	F01E171810	F01E241810
 Yellow	20	Box of 30	F01E172010	F01E242010
 Violet	22	Box of 30	F01E172210	F01E242210

Step5: Special Instruction for Tiemann Catheter

A special technique is required when using a Tiemann Catheter. Consult your healthcare provider for training and guidance.

Before inserting the catheter, take note of the position of the marker on the funnel in relation to the curved tip of the catheter. This will assist you in maintaining the correct direction of the curved tip during use.

Keep the curved tip directed upwards towards the stomach during insertion and throughout the catheterization process, including withdrawal.

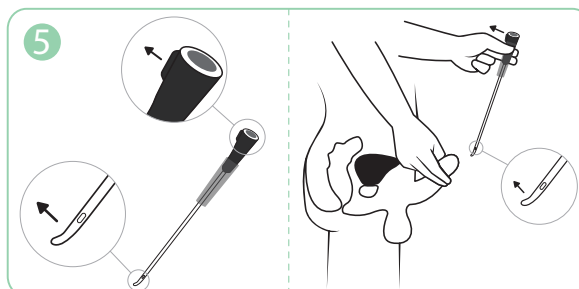

Instruction for use

ConviCath® & ConviCath® Pro

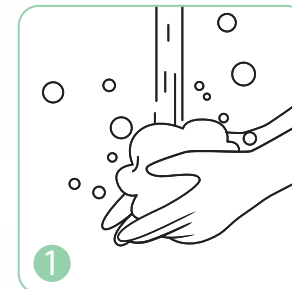

Wash hands thoroughly with soap and water.



Expose and clean the urethral orifice and the surrounding skin.

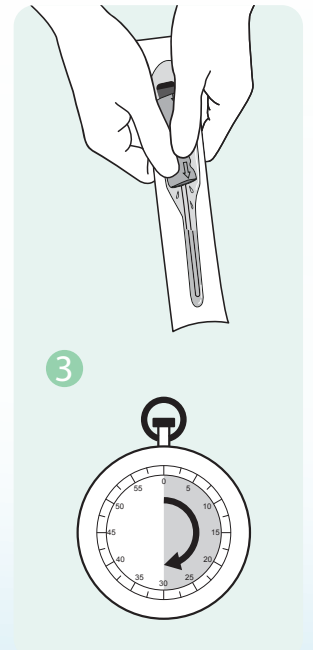

ConviCath® Only.
ConviCath® Pro skips directly to step 4.
Before opening the pouch, squeeze the water sachet and let the water run down into the package. Soak the catheter for at least 30 seconds to activate the hydrophilic coating.

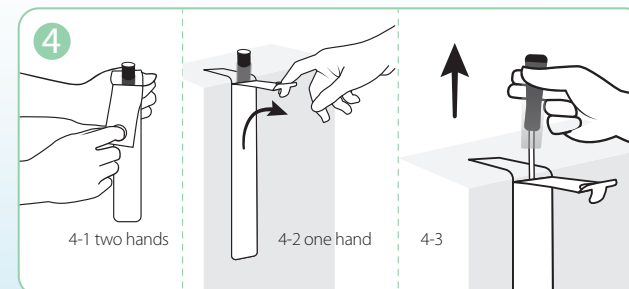

4-1 Tear open the catheter packaging from the tear notch until the connector is completely exposed. 4-2 Fix it to a dry surface using the adhesive tab or hang the package by its thumb grip. 4-3 Remove the catheter using the protective sleeve.

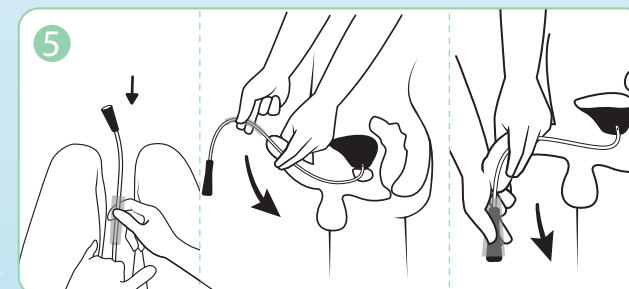

Expose the urethral opening again, and hold the catheter with the other hand, slowly insert it along the urethral opening and drain the urine into the toilet or other container.



Remove the catheter and discard it. Wash your hands.

ConviCath® Mini

Compact Standard

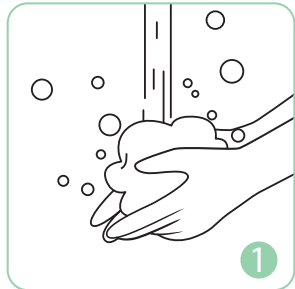

Wash your hands as advised.

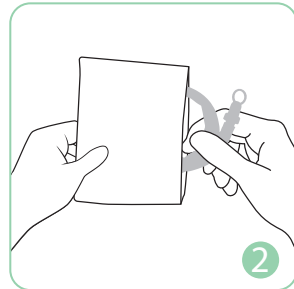

Open package and take out the catheter from package and lay it on the opened pack.

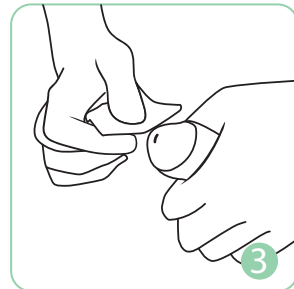

Expose the penis and hold it with your non-dominant hand until the procedure finish. Clean it and the surrounding skins.
Note: Pull back foreskin (if present).

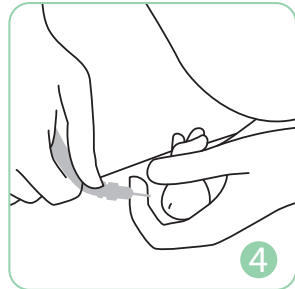

Remove the cap from the protective cover.

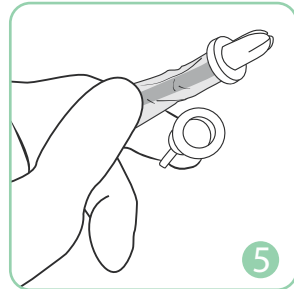

Hold the catheter and push it forward until the tip fills the protective cover, making sure it doesn't stick out.

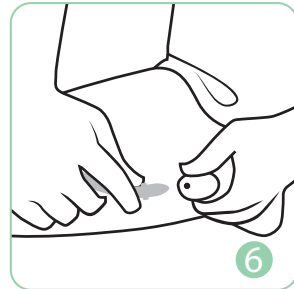

Grasp catheter below protective tip plate and expose the urethral opening using your fingers and forefinger of your non-dominant hand.

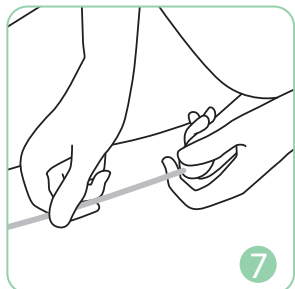

With your dominant hand, insert the protective tip until the plate comes in contact with urethral opening.



Then continuously insert the catheter until the urine starts to flow and open the sliding switch.



Removal the catheter when you're sure the bladder is empty and discard it.
DO NOT FLUSH DOWN TOILET
Wash your hands.

ConviCath® Mini

Compact Female

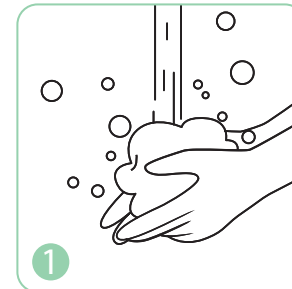

Always wash hands before use.



Expose and clean the urethral orifice and the surrounding skin.

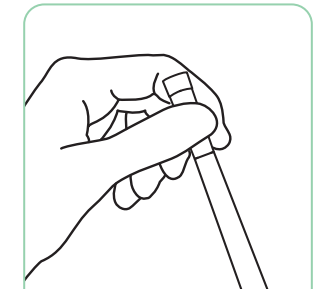

Hold the product vertically, twist the cap by holding the connector.

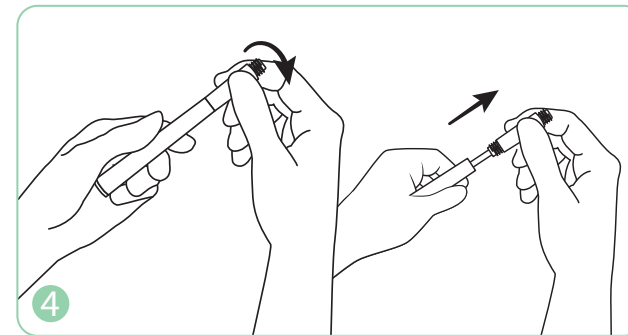

Twist the connector by holding the container, pull the catheter straight up out of the container. Empty the remaining fluid from the container (in the toilet or sink).

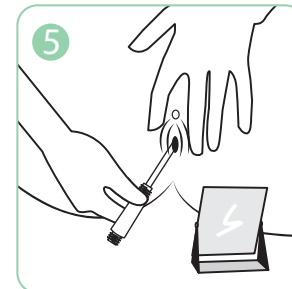

Insert the catheter into the urethra and drain the urine into the toilet or other container.



Dispose or carry it in your bag until disposal.

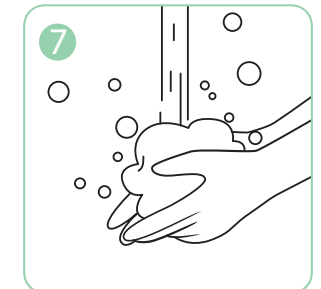

Wash your hands.